

## ENGINE LOCATION INDEX [ZJ, Z6]

B3E011015800W01

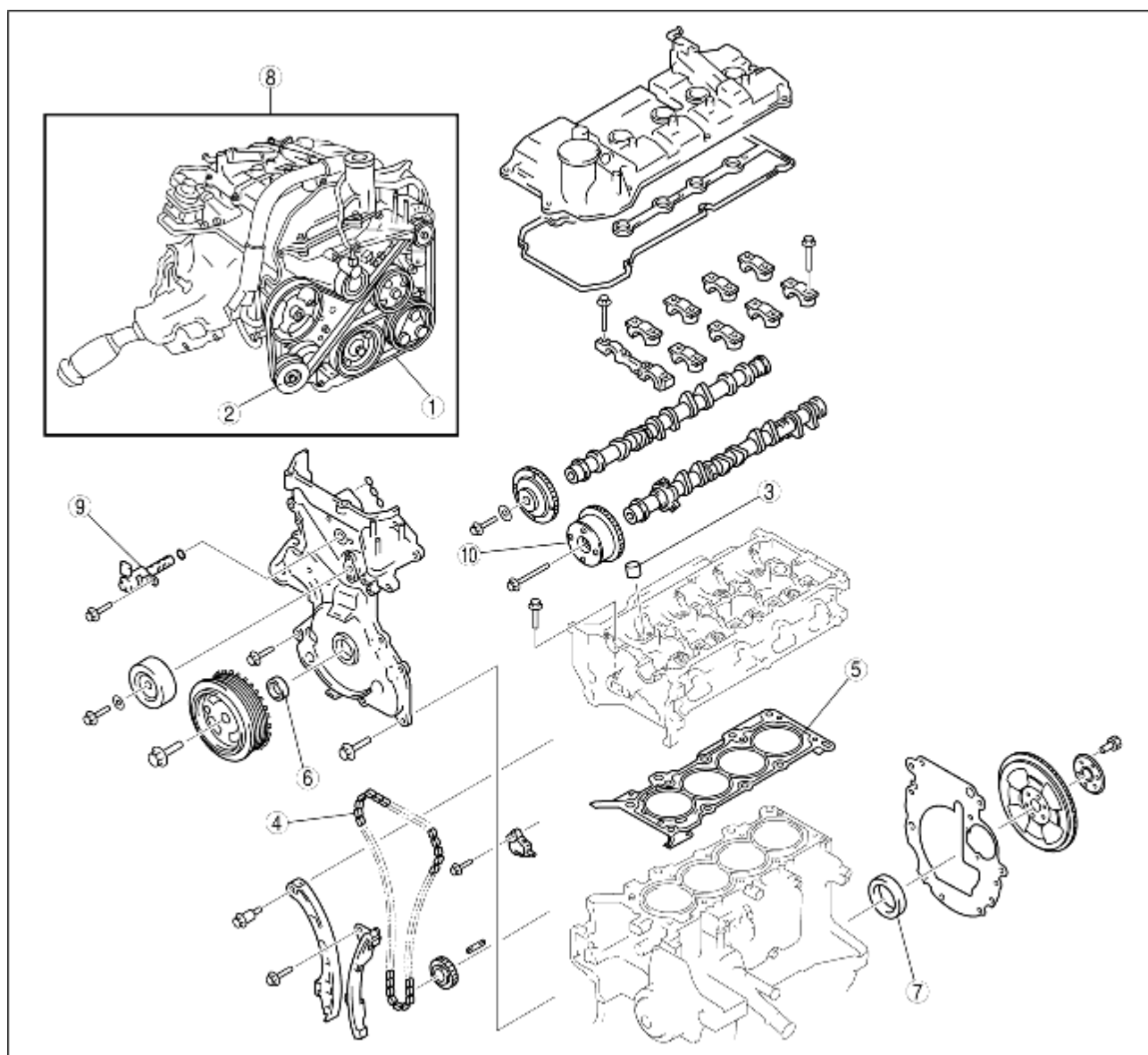

B3E0110W019

1	Drive belt (See <a href="#">DRIVE BELT INSPECTION [ZJ, Z6].</a> ) (See <a href="#">DRIVE BELT REPLACEMENT [ZJ, Z6].</a> )
2	Drive belt auto tensioner (See <a href="#">DRIVE BELT AUTO TENSIONER INSPECTION [ZJ, Z6].</a> )
3	Tappet (See <a href="#">VALVE CLEARANCE INSPECTION [ZJ, Z6].</a> ) (See <a href="#">VALVE CLEARANCE ADJUSTMENT [ZJ, Z6].</a> )
4	Timing chain (See <a href="#">TIMING CHAIN REMOVAL/INSTALLATION [ZJ, Z6].</a> )
5	Cylinder head gasket

	(See <a href="#">CYLINDER HEAD GASKET REPLACEMENT [ZJ, Z6].</a> )
6	Front oil seal (See <a href="#">FRONT OIL SEAL REPLACEMENT [ZJ, Z6].</a> )
7	Rear oil seal (See <a href="#">REAR OIL SEAL REPLACEMENT [ZJ, Z6].</a> )
8	Engine (See <a href="#">COMPRESSION INSPECTION [ZJ, Z6].</a> ) (See <a href="#">ENGINE REMOVAL/INSTALLATION [ZJ, Z6].</a> ) (See <a href="#">ENGINE DISASSEMBLY/ASSEMBLY [ZJ, Z6].</a> )
9	Oil control valve (OCV) (See <a href="#">OIL CONTROL VALVE (OCV) INSPECTION [ZJ, Z6].</a> ) (See <a href="#">OIL CONTROL VALVE (OCV) REMOVAL/INSTALLATION [ZJ, Z6].</a> )
10	Variable valve timing actuator (See <a href="#">VARIABLE VALVE TIMING ACTUATOR INSPECTION [ZJ, Z6].</a> ) (See <a href="#">VARIABLE VALVE TIMING ACTUATOR REMOVAL/INSTALLATION [ZJ, Z6].</a> )